



ImproX RL

Product Specification Catalogue

The ImproX (RL) Registration Interface supports a USB interface.

The Registration Interface performs the following functions:

- Acts as an authentication device, interfacing with the IXP400 Utilities and Access Modules.
- Registration of 125 kHz and 13.56 MHz Tags into our IXP400 Software. (An ImproX RRA or ImproX RRM is required for this functionality).
- Converts USB to RS485 and Ethernet (typically UDP).

Key Features

- The Antenna Port allows connection to the ImproX (RRA) Registration Antenna Reader (preferred option) or alternatively the standard range of ImproX Antenna Readers.
- The Third-party Port can be used to connect to one of the following: Barcode, Magstripe, Wiegand, Biometric Readers or the ImproX (RRM) MIFARE® Registration Remote Reader.
- Read capability using the following (125 kHz) Impro Tags: Slim Tags, Omega Tags, WriTag 128 and WriTag 2048.
- Read capability using HID 125 kHz Tags.

NOTE: *HID is a registered trademark of HID Global Corporation (an ASSA ABLOY Group Brand).*

- Read Capability using MIFARE® (13.56 MHz) Tags.
- The Registration Interface offers a simple user interface, consisting of four "Diagnostic Indicators" and one "Power Indicator" (Power LED).
- A four volume, single tone Buzzer (Software dependent), located at the ImproX RRA or RRM.
- A Bi-colour Red or Green Status LED located at the ImproX RRA or RRM.
- Infrared registration. The Infrared Receiver is located in the extrusion of the ImproX RL, alongside the USB Plug.
- Can connect to the Ethernet using a standard Network Cable with an RJ45 connector at one end.

Physical Specifications

Part Number

Length	: 84 mm (3.31 in).
Width	: 116 mm (4.57 in).
Height	: 54 mm (2.13 in).
Approximate Weight	: 353.4 g (12.46 oz) excluding the USB Cable.
Mounting Plate	: Aluminium.
Colour	: Black.

ImproX (RL)

Registration Interface

XRL900-1-0-GB-XX

Environmental Specifications

Operating Temperature	: -25°C to +60°C (-13°F to +140°F).
Storage Temperature	: -40°C to +80°C (-40°F to +176°F).
Humidity Range	: 0 to 95% relative humidity at +40°C (+104°F) non-condensing.

Approvals

CE Approval	: TBA.
FCC Approval	: TBA.

Dust & Splash Resistance	: The ImproX RL is designed to work in an indoor (dry) environment similar to IP20. The ImproX RL is, therefore, not sealed against water.
--------------------------	--

Drop Endurance	: 2 m (6.56 ft) drop (in packaging).
----------------	--------------------------------------

Electrical Specifications

Power

Input Voltage	: 10 V DC to 30 V DC.	
Power Requirements		
	Current (mA)	Power (W)
Input Voltage 10 V DC	: 210	2.1
Permissible Input Supply		
Ripple Voltage (Max)	: 0.2 V _{PP} at 50 Hz.	

Third-party Port

Electrical Interface	: 5 V DC ± 0.1 V is supplied to power the single Reader connected to this Port. A maximum of 100 mA can be supplied from this Port.
----------------------	---

Factory Defaults

Baud Rate	: Factory-set to 38 400.
-----------	--------------------------

User Interfaces

LED Indicators

Power LED	: Blue (steady) (externally visible).
USB Tx LED	: Red (flashing) (internally visible).
USB Rx LED	: Green (flashing) (internally visible).
RS485 Tx LED	: Red (flashing) (internally visible).
RS485 Rx LED	: Green (flashing) (internally visible).

ImproX RRA or RRM

Status LED	: Bi-colour, Red or Green LED.
Buzzer Volume & Tone	: Four volume, single tone (Software dependent).



Related Information

For extra information relating to this product refer to the:

- ImproX RL Hardware Installation Manual (XRL300-0-0-GB-XX).

Warranty Details

This product conforms to our Warranty details on www.impro.net.

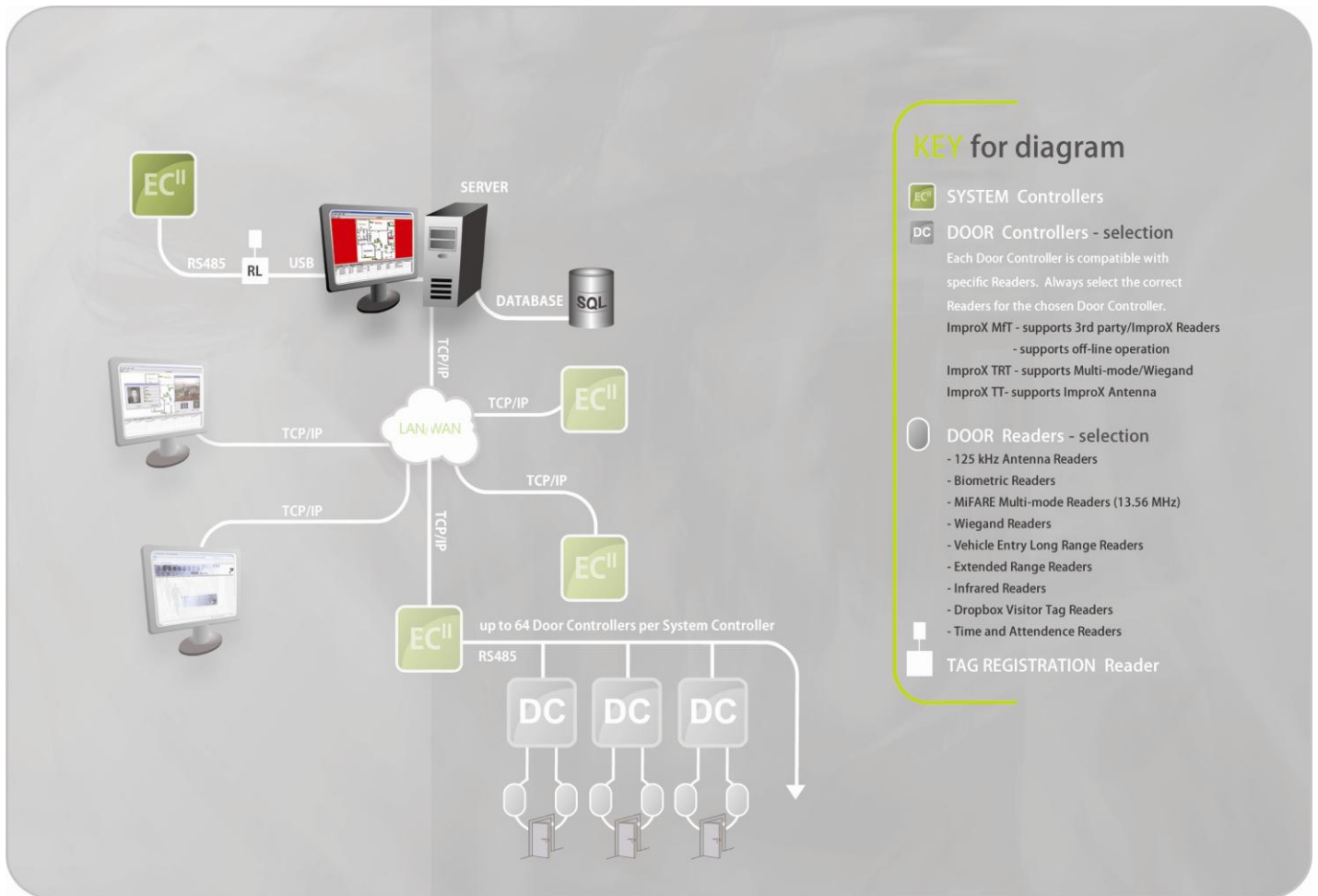

Figure 1: ImproX RL System Overview

This Product Specification Catalogue applies to the ImproX (RL) Registration Interface, XRL900-1-0-GB-05.
(The last two digits of the Impro stock code point to the issue status of the document or product).

XRL350-0-0-GB-05	Issue 06	April 2009	ImproX RL\Product Specification Catalogue\LATEST ISSUE\ImprX RL-psc-en-06.docx
------------------	----------	------------	--